

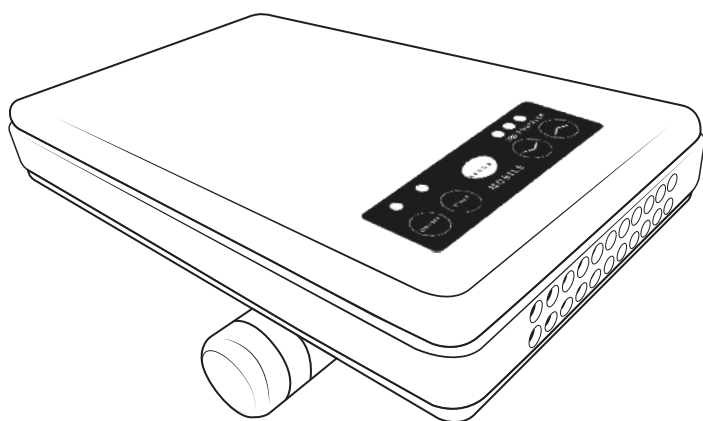

MOBILE



## Portable Electronic Purifier

**READ MANUAL CAREFULLY FOR PROPER PROCEDURES AND OPERATION.**

**ActivePure®**  
TECHNOLOGY



2017 Space Technology  
Hall of Fame Inductee

GENERAL INFORMATION

PRODUCT OVERVIEW

Congratulations, you have purchased one of the most effective, technologically advanced mobile air purifier available. Your new Aerus Mobile is designed to provide clean, healthy air for your car, truck, RV, or camper by reducing airborne contaminants, odors and pollutants. Be sure to read and follow all service procedures outlined in this owner’s manual, and use only genuine Aerus replacement parts available from your Independent Distributor/Contractor.

CONTENTS

Specifications ..... 2

Important Safety Instructions ..... 3

Parts and Accessories ..... 4

Control Pad Layout ..... 5

Operation ..... 5

Mounting the Base ..... 5

Adjusting the Wire Stand ..... 6

Wire Stand Positions ..... 6

12VDC Adapter Fuse ..... 6

Power Adapters ..... 7

Portability ..... 7

Disassembly ..... 8

Assembly ..... 9

Yearly Maintenance ..... 9

Cleaning ..... 10

Troubleshooting ..... 10

SPECIFICATIONS

- Aerus Mobile**
- 50111 Model: A1018D
  - Meets California ozone emissions limit. CARB Certified.
- Technology:**
- ActivePure® Technology
- Electrical:**
- 12VDC or 110 - 240 VAC 50/60Hz
  - Fuse (12V DC adapter only): 2 Amp Buss type
  - Maximum 10.7 Watts
- Mechanical:**
- 3 Speed Fan
- Operating Temperature:**
- 45°F - 100°F (7°C - 38°C)
- Dimensions:**
- 3.625" x 6" x 1.0"
  - (9.21cm x 15.25cm x 2.54cm w/o base)
- Weight:**
- 8 ounces (.23kg)
- Warranty:**
- Limited (1) year

Please record the name and phone number of your Independent Distributor/Contractor here, and retain it for future reference.

Name \_\_\_\_\_

Phone \_\_\_\_\_

Serial # \_\_\_\_\_

DID YOU FORGET TO REGISTER YOUR AERUS MOBILE?

By registering, you'll activate your warranty. Your privacy is guaranteed. Just fill out your warranty card and drop it in the mail.

**If you have any questions concerning this, or any Aerus product, contact your Independent Distributor/Contractor or Aerus Customer Service at 800.243.9078 (U.S.) or 800.668.0763 (CANADA).**

## IMPORTANT SAFETY INSTRUCTIONS

---



- CAUTION:**
- Not for use on 12 volt positive ground or 24 volt vehicles; doing so may damage the product
  - Do not operate unit near heat sources, open flame, or combustible vapors or gases
  - The unit must be disconnected from its power source before servicing, and should not have the power reconnected unless the case is correctly and completely reassembled



**WARNING:** UV Lamp operation; do not operate this unit unless the case is completely and correctly assembled. Failure to comply may result in serious eye damage.

**Read this manual in its entirety before using your Aerus Mobile.**

- Disconnect power cord before servicing
- DO NOT immerse in water or other liquids
- DO NOT touch the control panel or plug with a wet hand
- DO NOT insert or allow foreign objects to enter any ventilation or exhaust opening as this may cause an electric shock or fire, or damage the air cleaner
- To prevent a possible fire, DO NOT block the air intakes or exhaust in any manner; DO NOT use on soft surfaces, where openings may become blocked
- To disconnect air cleaner, turn controls to OFF, then remove plug from outlet; pull firmly on the plug, DO NOT unplug by pulling on the cord
- Always unplug the unit before moving or cleaning, or whenever the air cleaner is not in use
- DO NOT use outdoors or on wet surfaces
- DO NOT attempt to repair or adjust any electrical or mechanical functions on this unit, doing so will void your warranty
- Connect to properly grounded outlets only
- To reduce the risk of electrical shock, do not change the plug in any way

**SAVE THESE INSTRUCTIONS**

**PARTS AND ACCESSORIES**

A. WIRE STAND .....	9950153
B. BASE .....	9950154
C. KNOB/CLAMP PACK (2) .....	9950155
D. 12VDC ADAPTER .....	9950157
E. 2.0 AMP FUSE .....	9950162
F. AC ADAPTER .....	9950158

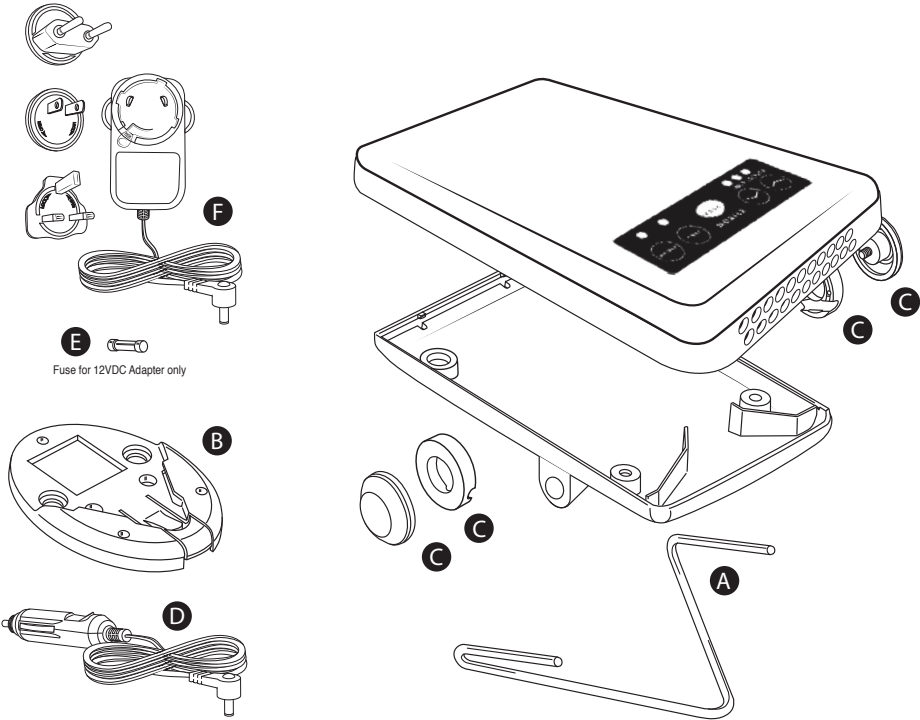

## CONTROL PAD LAYOUT

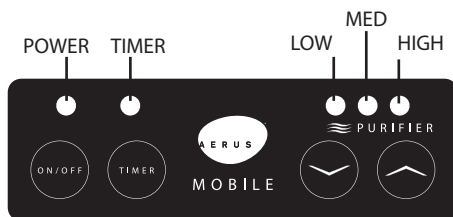

## OPERATION



- CAUTION:**
- DO NOT operate the Aerus Mobile continuously 24/7 as doing so may cause overheating
  - DO NOT place unit where it may be exposed to temperatures above 100°F as doing so may cause the plastic to deform

1. If desired, mount the base in an appropriate location (see below).
2. Adjust the wire stand (see page 5).
3. Plug in either the 12VDC car adapter or the AC adapter.
4. The Aerus Mobile unit will turn on when power is supplied to the unit.

**ON/OFF:** When pressed, the unit turns on or off. LED above button will be lit when unit is on.

**TIMER:** When pressed, it turns the Timer on for 4 hours, then turns off. LED above button will be lit when the Timer is on.

**NOTE:** If Timer is not pressed, the unit will operate continuously, until turned off or unplugged.

**PURIFIER:** Adjusts the Purifier Fan by pressing the Purifier UP and Purifier DOWN buttons.

5. When the unit is off, all the LED lights will also be off.

## MOUNTING THE BASE

The base for the Aerus Mobile can be mounted using the included suction cups, Velcro, or screws, depending on preference. When using suction cups or Velcro, be sure the surface is smooth and clean. Dirt, grease, protectants, and other substances will affect performance and holding ability.

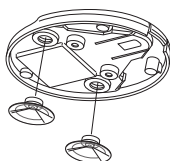

1. Attach suction cups by pressing and twisting into the base, or...

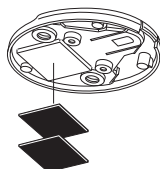

2. Peel and stick one part of the Velcro to the base, then attach the other to a clean, dry surface, or...

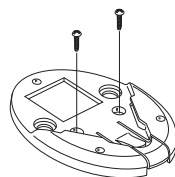

3. Screws may be used for extra security and where the other methods are not appropriate.

## ADJUSTING THE WIRE STAND

The wire stand on the Aerus Mobile allows for quick release from the base, provides a stand or hanger for the unit independent of the base, and allows the unit to either stand or hang from the base depending on how the base is mounted.

To adjust the wire stand, loosen the two knobs on the sides of the unit approximately 1/2 turn. The unit may then be tilted up or down to adjust the angle or moved on the wire stand to change the height. You can also remove and change the position of the wire stand to accommodate several different mounting methods. To reinstall, simply align the two clamp collars and insert the wire stand. Once the unit is adjusted, tighten both knobs to hold it in place.

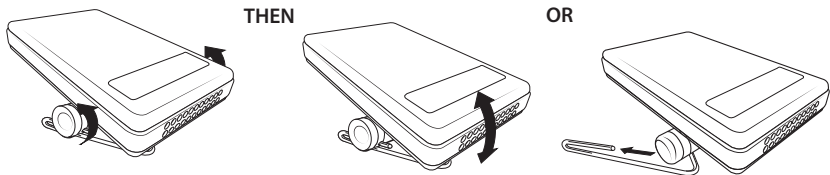

## WIRE STAND POSITIONS

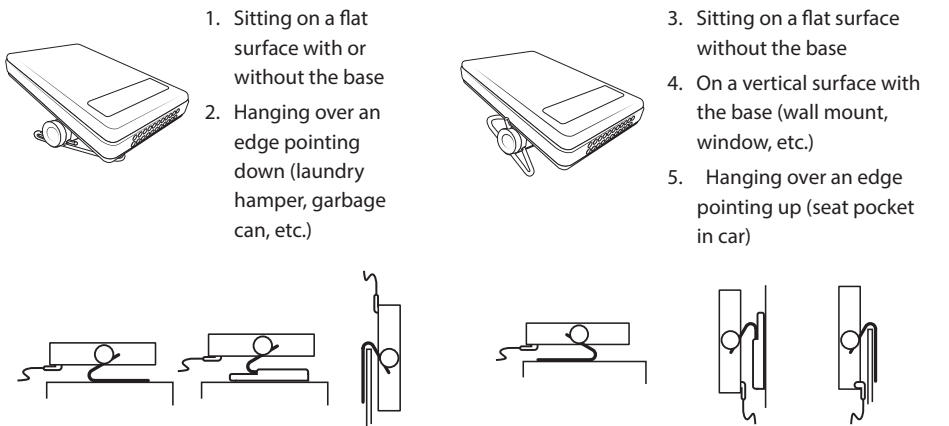

**NOTE:** Unit can be used without attaching the base or wire stand.

## EFFECTS OF HIGH OR LOW VOLTAGES ON AERUS MOBILE™ WHEN USING THE 12VDC CAR ADAPTER

The Aerus Mobile™ has an operating voltage range of 11 VDC to 14.6 VDC. If the voltage coming into the unit is too high, the unit may blow the 12VDC adapter fuse. This type of problem usually indicates something is wrong with a vehicle's electrical system. If the unit shuts down while using the 12VDC automotive adapter and you are unsure of the cause, check the adapter fuse. If the fuse is not blown, test the unit using the supplied AC adapter. Once the voltage problem (drained car battery, electrical system problem, etc.) is corrected by a qualified service person, you will be able to resume using your Aerus Mobile™ with the 12VDC adapter.

# POWER ADAPTERS



**CAUTION:** Not for use on 12 volt positive ground or 24 volt vehicles. Doing so may damage the product.

The Aerus Mobile comes with both a 12 volt DC car adapter and a 100 - 240 volt 50/60 Hz AC adapter with interchangeable plugs.

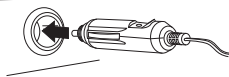

Insert the car adapter into an appropriate 12 volt automotive type power outlet.

## 12VDC Adapter Fuse

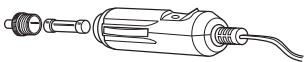

To change the car adapter fuse, unscrew and remove the front of the adapter. Replace with the same type and rating only: 2 amp Buss type fuse (service part #9950162).

**NOTE:** For proper operation using the 12 volt car adapter, make sure the the fit in the power outlet is snug. A loose fit may can issues in unit operation or blown fuses.

OR



Select and install the proper international plug into the AC adapter. Insert correctly assembled adapter into a standard electrical outlet.

**NOTE:** when installing one of the interchangeable plugs, be sure to twist and lock it into place. When removing a plug, press the raised tab to release, then turn the plug out the top.

THEN

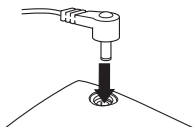

Insert the small adapter plug into the opening located underneath at the rear of the unit.

# PORTABILITY

Depending on how it is mounted, your Aerus Mobile can be ready to take with you in just a few seconds.

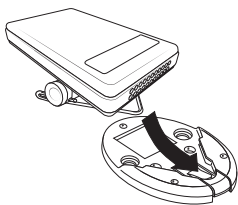

1. Once the unit is assembled and the base mounted, simply snap the wire stand into the base. The latch at the front of the base should snap into place, locking in the stand and unit.

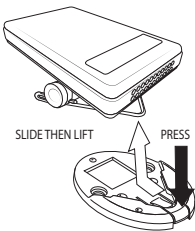

2. To remove the unit from an attached base, press down on the front latch and slide the unit back, then up.

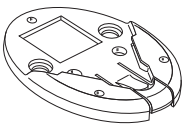

3. For added convenience, mount extra bases where you use your Aerus Mobile most. See your Independent Distributor/Contractor for more information.

**NOTE:** If you prefer to remove the base and unit together, mount the base with Velcro or suction cups to a clean, dry surface.

## CLEANING

---



**CAUTION:** The unit must be disconnected from its power source before servicing, and should not have the power reconnected unless the case is correctly and completely reassembled.

Depending on environmental conditions, your Aerus Mobile will require periodic cleaning every one to three months.

**ActivePure® Target** - Clean the target by gently removing dust with a small, soft brush.

**UV Bulb** - The UV bulb should be gently wiped with a soft, dry cloth. Avoid handling the UV bulb more than necessary.

**Case** - Clean the exterior case of your Aerus Mobile with a soft cloth dampened (not wet) with water. Do not use harsh chemicals or solvents.

**Fan/Interior of unit** - The interior and fan may be cleared of dust using canned air suitable for electronics.

**NOTE:** See Maintenance Instruction Sheet for detail views of components.

## TROUBLESHOOTING

---



**WARNING:** Under no circumstances should your Aerus Mobile unit be operated while any part of the case is damaged, missing, or disassembled. If the case is damaged, return your unit to your Independent Distributor/Contractor for repair or replacement. Direct exposure to the internal UV light may cause eye damage.

**Unit does not operate/ all LEDs off:**

- Unplug and reinsert the adapter plug and adapter to check where the power supply is plugged in to be sure it has power.
- If using the 12VDC car adapter, remove the fuse by unscrewing the end of the adapter and check to see if it is blown. Replace it with the same type and rating fuse only (see Specifications).

**NOTE:** If the fuse is not blown, check the outlet for proper voltage.

**UV bulb may not be working:**

- Press the PURIFIER UP or PURIFIER DOWN buttons to turn the Purifier function ON.
- If cleaning and reinstalling does not correct the problem, replace the Bulb Assembly (service kit #9950209).
- When looking through the rear inlet vents in low light you should see a slight bluish glow. If there is no glow, replace the Bulb Assembly (Service Kit #9950209).

**Lack of air flow:**

- Make sure the intake vents are not blocked and the front of the unit is clear.
- Check to see if the fan is operating (if not, see above).

**If your unit fails to operate properly after performing troubleshooting, contact your Independent Distributor/Contractor or Aerus Customer Service at 800.243.9078 (U.S.) or 800.668.0763 (CANADA) for additional support.**



## LIMITED 1 YEAR WARRANTY

---

### WHAT IS COVERED BY THIS WARRANTY

We warrant the Aerus Mobile to the consumer, subject to the conditions below, against defects in workmanship or material, provided that the products are returned to a service location within the following time periods:

- Aerus Mobile within one (1) year of date of purchase.

### INSTALLATION AND MAINTENANCE REQUIREMENTS

This warranty is expressly conditioned upon proper installation, operation, cleaning and maintenance, all in accordance with the Owner's Manual. Failure to meet any of these requirements will void this warranty. Servicing of your Aerus Mobile by parties other than our authorized representative and/or using parts other than genuine parts will also void this warranty.

### HOW TO OBTAIN WARRANTY SERVICE

Customer must contact Aerus Customer Service or their Independent Distributor/Contractor and provide proof of purchase within the above time period. We will repair or replace and return the product, without charge and within a reasonable period of time, subject to the conditions in the above paragraphs, if its examination shall disclose any part to be defective in workmanship or material. If we, in our discretion, are unable to repair the product after a reasonable number of attempts, we will provide either a refund of the purchase price or a replacement unit, at the company's option.

### WHAT IS NOT COVERED BY THIS WARRANTY

This product is intended for household use only. Ordinary wear and tear shall not be considered a defect in workmanship or material. These warranties do not apply to filters nor for loss or damage caused by accident, fire, abuse, misuse, improper installation, modification, misapplication, commercial use, or by any repairs other than those provided by our authorized Service Center.

### MISSING SERIAL NUMBERS AND UNAUTHORIZED CHANNELS

If a valid serial number is missing from the product, the warranty will be voided. Aerus products are authorized for sale through Aerus Independent Distributors/Contractors only. Warranties are voided if a product is purchased through unauthorized channels, this includes websites that are not authorized to use Aerus trademarked names, images and logos as well as Internet auction sites (e.g. ebay and Craigslist). The only approved Internet presence for Aerus products is [www.aerushome.com](http://www.aerushome.com). To confirm warranty coverage prior to purchasing a product, contact Aerus Customer Service at **800.243.9078 (U.S.)** or **800.668.0763 (CANADA)** with the serial number located on the back of the unit.

### EXCLUSION OF OTHER WARRANTIES AND CONDITIONS

EXCEPT AS PROVIDED HEREIN, WE MAKE NO REPRESENTATION OR WARRANTY OF ANY KIND. ALL OTHER WARRANTIES OF ANY KIND, EXPRESS OR IMPLIED, ARE HEREBY EXPRESSLY DISCLAIMED, INCLUDING ANY IMPLIED WARRANTY OF MERCHANTABILITY OR FITNESS FOR A PARTICULAR PURPOSE.

### LIMITATION OF LIABILITY FOR SPECIAL, INCIDENTAL, OR CONSEQUENTIAL DAMAGES

WE SHALL NOT IN ANY CASE BE LIABLE FOR SPECIAL, INCIDENTAL OR CONSEQUENTIAL DAMAGES ARISING FROM BREACH OF EXPRESSED OR IMPLIED WARRANTIES, CONDITIONS, GUARANTEES OR REPRESENTATIONS, BREACH OF CONTRACT, NEGLIGENCE OR ANY OTHER LEGAL THEORY. Such excluded damages include, but are not limited to, loss of profits or revenue, and loss of the use of the products.

### FOR U.S. APPLICATION ONLY

This warranty gives you specific legal rights, and you may also have other rights which vary from state to state. Some states do not allow limitations on warranties, or on remedies for breach. In such states, the above limitations may not apply to you.

#### **This warranty is provided by:**

Aerus, LLC  
The Aberdeen Bldg.  
14841 Dallas Parkway, Suite 500  
Dallas, TX 75254

### SERVICE

Every effort is made to ensure customers receive an up-to-date instructions manual on the use of our products; however, from time to time, modifications to our products may without notice make the information contained herein subject to alteration. For the latest information, please visit our web site.





## FCC Declaration of Conformity

**Name:** Aerus Mobile

**Model:** A1018D

**Manufacturer:** Aerus, LLC

This device complies with Part 15  
of the FCC Rules.

## RESPONSIBLE PARTY

Aerus, LLC  
The Aberdeen Bldg.  
14841 Dallas Parkway, Suite 500  
Dallas, TX 75254  
Ph: 800.243.9078 (U.S.)

**Signature:** \_\_\_\_\_

**Printed Name:** Andrew Eide

**Title:** Vice President of Product Development  
and Manufacturing

**Date:** 06/25/2021

This equipment has been tested and found to comply with the limits for a Class B digital device, pursuant of part 15 of the FCC Rules. These limits are designed to provide reasonable protection against harmful interference in a residential installation. This equipment generates, uses, and can radiate radio frequency energy, and if not installed and used in accordance with the instructions, may cause harmful interference to radio communications. However, there is no guarantee that interference will not occur in a particular installation. If this equipment does cause harmful interference to radio or television, which can be determined by turning the equipment off and on, the user is encouraged to try to correct the interference by one or more of the following measures:

Reorient or relocate the receiving antenna.

Increase the separation between the equipment and receiver.

Connect the equipment into an outlet on a circuit different from that to which the receiver is connected.

Consult the Independent Business Owner for help.



For information regarding the use of this product please call Customer Service.

**800.243.9078 (U.S.)**

**800.668.0768 (CANADA)**

**[www.aerushome.com](http://www.aerushome.com)**

Aerus, LLC | The Aberdeen Bldg. | 14841 Dallas Parkway, Suite 500 | Dallas, TX 75254 | 800.243.9078

© 2021 Aerus LLC. All Rights Reserved